

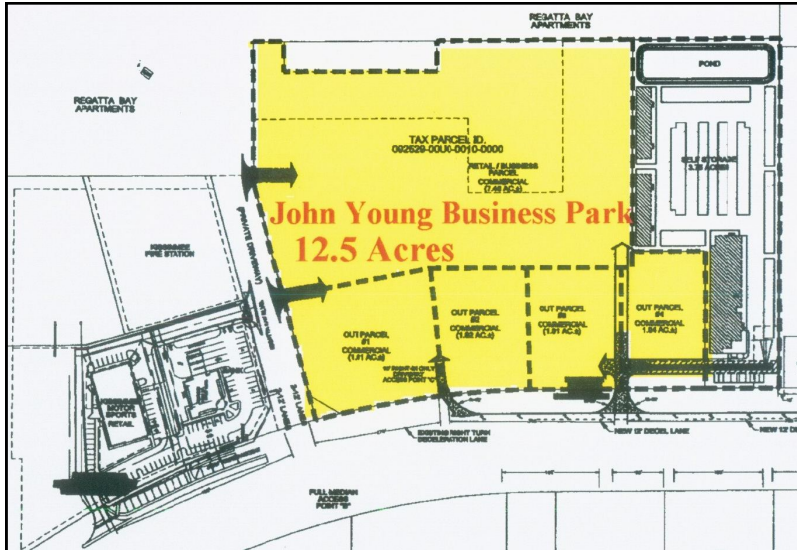

John Young Business Park

12.5 Acres Available in Kissimmee



Highlights of this Property

**Commercial
Retail
Office
Flex Space Use
Zoned PUD**

Features:

- Ideal location in the high growth area of The Loop Shopping Area in Kissimmee
- Property fronts on busy John Young Parkway that leads to Lowe's, Best Buy, Osceola PKWY and Hunter's Creek
- Easy access to the Florida Turnpike & I-4
- Water and Sewer available
- Less than 5 miles from most Central Florida Attractions
- High Traffic Counts



SchoolfieldProperties.com

101 Park Place Blvd., Suite 3
Kissimmee, FL 34741

Phone: (407) 847-3099

Fax: (407) 847-2850